

CHEST GUARD

Velcro back connection and elastic strap allows adjustments for optimum fit!
Size: S, M, L, XL
RH/LH

Colors



BLACK



WHITE



RED



BLUE



FOLDING BOWSTAND

The award-winning original folding bowstand. A long selling favorite!

Colors



BLACK



SHIBUYA TAB

Featuring premium ergonomics and premium cordovan faces at an affordable price point.
Available Sizes: S, M, L
RH/LH available.



2020-2021

ULTIMA - The next generation of ultimate performance.

The ULTIMA brand embodies SHIBUYA's
ambition to deliver a new dimension of
highest archery performance.

Revolutionary innovation made possible by
Japanese manufacturing technology take this
endeavor to a new level
with the introduction of these new products.

New!
ULTIMA RC PRO
TARGET RECURVE SIGHT

New!
ULTIMA CPX II
SCALE MAGNIFIER

New!
ULTIMA
OKULUS SCOPE

New!
ULTIMA MZS
MINIMIZED DRAG ZONE DAMPING STABILIZER

New!
ULTIMA EXTENDER



The top-of-the-line recurve sight,
featuring every feature you've ever dreamed of.
ULTIMA RC PRO's radically redesigned carbon
extension redefines vibration elimination.

ULTIMA RC PRO TARGET RECURVE SIGHT

New!

Colors



Polygonal Carbon Extension

ULTIMA RC PRO's carbon extension features a radical new design redefining vibration elimination. The ultimate goal of eliminating vibration through the shape of the carbon extension lead us to a fishing pole taper shape. Through it, ULTIMA RC PRO is able to eliminate most of the unnecessary vibration on the shot. In simulations, the Polygonal Carbon Extension produces 87% less initial vibrations than the conventional shape.

Additionally, SHIBUYA has applied the concept of "spine" to the extension, tailoring to a wide variety of archers' desired shooting feel by including two different stiffnesses of the Polygonal Carbon Extension in the lineup.

By targeting vibration not only through material, but also shape, ULTIMA RC PRO offers a shooting feel like never before.

Redesigned Mounting System

ULTIMA RC PRO features a brand-new mounting mechanism to achieve a more secure lock than ever. By increasing the knob's diameter, and maximizing the contact area with the carbon extension, ULTIMA RC PRO's mount achieves a rattle-proof lock with less effort required than ever. Never worry about the knob coming loose again with this simple yet secure mounting system!

Sight Scale Plates

Both sides of ULTIMA RC PRO's elevation bar feature metal sight scale plates. Each ULTIMA RC PRO includes a standard scale plate, as well as a blank plate for a printed tape. Left and right are interchangeable, to fit any archer's preferred shooting style.

Redesigned Sight Pin Locker

ULTIMA RC PRO features a redesigned sight pin locker with a toolless thumb screw. Enjoy an effortless shooting experience that not only improves usability, but cuts down on the time needed for adjustments by eliminating the hex wrench for adjustments.

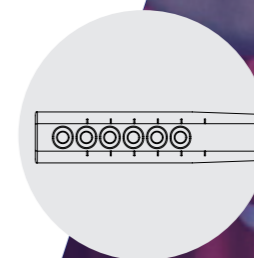

Models	RC PRO
Extension bar	9" Polygonal Carbon Extension Type:AorB
Elevation lengths	5.2"
Weight	233g(Type:A) 221g(Type:B)
Anodized Colors	Black Silver Blue Red Gold Pink Green Orange



The World's most popular
Recurve Sight Evolved.

ULTIMA RC II

TARGET RECURVE SIGHT



Colors

BLACK

SILVER

BLUE

RED

GOLD

PINK

GREEN

ORANGE

Precise, Hassle-Free Adjustments

ULTIMA series sights feature a precise, ultra-smooth lever locking mechanism. Coarse adjustments are quick to make by pressing the release lever, and simply sliding the windage unit to the desired position. The micro-adjustment dial provides 0.002" of travel per click, at 20 clicks per revolution. All Adjustments are compatible with popular configuration software.

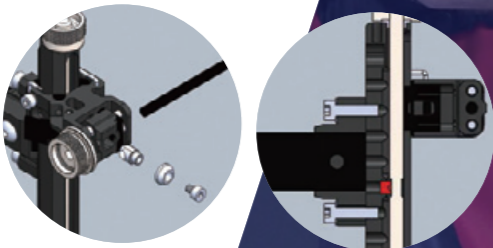

- Micro-Adjustment Travel - .002" per click (windage/elevation) 20 clicks per revolution
- Serrated release lever for smooth, easy adjustments
- Laser-etched sight scales compatible with popular configuration software
- Field-adjustable, field-replaceable components - no need for factory repairs
- Includes soft carrying case and metric allen wrenches

Models	UL-RCII
Extension bar	9" Carbon
Elevation lengths	4.85"
Weight	201g
Anodized Colors	Black, Silver, Blue, Red, Gold, Pink, Green, Orange

X-Lock System

Re-adjustable, zero-tolerance fit between the windage unit and sight frame. Super-slick and durable polyacetal resin guide spacers enclose the elevation rail, re-adjustable at the turn of a set screw. All parts field-adjustable and -replaceable!
Protected under US Pat No. 7,287,335



Proven Success

No other sight has helped more archers win their spots on the podium in the international target circuit than SHIBUYA's ULTIMA and DUAL CLICK series. More participants and more Medalists in Rio used SHIBUYA sights than all other brands combined! Find out more about SHIBUYA's Shooting Staff's achievements at www.shibuya-archery.com!



Smooth and reliable adjustments
Light but incredibly sturdy
The Choice of top shooters worldwide!

ULTIMA CPX II

TARGET COMPOUND SIGHT

Colors

BLACK

SILVER

BLUE

RED

GOLD

PINK

GREEN

ORANGE



ZPE System

ULTIMA CPXII sights feature a revolutionary system eliminating backlash and play in the elevation adjustments: the ZPE system. A readjustable(1) aluminum wedge, secured with Nord-Lock® washers, eliminates any gap between the threaded locking block and aperture block.

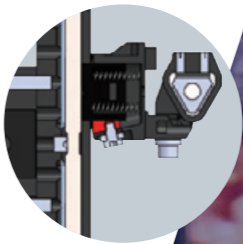

Indecater Pins

The new flat-shelf indicator pin on ULTIMA CPXII sights is easy to adjust, closer to the sight tape surface than ever before, while still offering enough clearance for layered tapes. Both side pins are locked by a cap screw from the side, preventing accidental movements when locking them down!

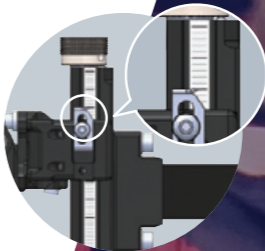

Tria-Lock System

Ultima CPX's scope rod is threaded through the windage block, offering an unprecedented level of stability and ruggedness, while preserving the outstanding light weight of the ULTIMA series! The innovative new Tria-Lock system encloses the entire windage slider from three sides, keeping it perfectly aligned and without play to produce a rattle-free, zero-tolerance environment.

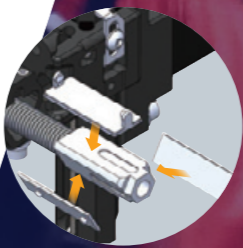

Keeping the scope rod close to the elevation rail - The key to stability
SHIBUYA's innovative Tria-Lock system keeps the scope rod approx. 1/2" closer to the elevation bar than conventional target sights. This significantly reduces moment effected on the windage unit - a significant factor in development of play and faults!

X-Lock System

Re-adjustable, zero-tolerance fit between the windage unit and sight frame. Super-slick and durable polyacetal resin guide spacers enclose the elevation rail, re-adjustable at the turn of a set screw. All parts field-adjustable and -replaceable!
Protected under US Pat No. 7,287,335

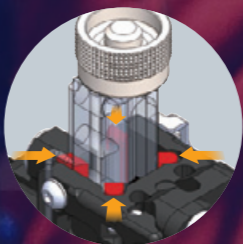

Models	UL-CPXII 365		ULII-CPXII 485	
Extension bar	Carbon			
Extension length	6"	9"	6"	9"
Elevation lengths	3.65"		4.85"	
Weight	199g	217g	207g	226g
Anodized Colors	Black, Silver, Blue, Red, Gold, Pink, Green, Orange		Black, Silver	

- wedge-locking NORD-LOCK® washers for absolute vibration resistance
- Micro-Adjustment Travel - .002" per click (windage/elevation) 20 clicks per revolution
- Integrated 2nd and 3rd axis adjustment
- Extra-large release lever for smooth, easy adjustments
- Laser-etched sight scales compatible with popular configuration software
- Field-adjustable, field-replaceable components - no need for factory repairs
- Includes soft carrying case and metric allen wrenches

ULTIMA CPX II

SCALE MAGNIFIER

New!

The ULTIMA Sight Scale Magnifier mounts to the flat shelf indicator's groove, enabling higher precision elevation adjustments than ever.

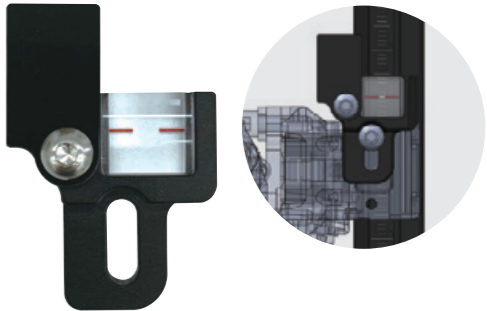



Customizable and perfectly balanced.
A fully featured scope
with a brand new twist!

ULTIMA OKULUS SCOPE *New!*

This state-of-the-art compound scope was developed with utmost care for balance, enabling it to fit to any configuration. The brand new Gravity Shift technology enables the scope to compensate for shifting center of gravity when using the large variety of accessories, such as sun shades and decal rings. OKULUS strikes the balance for a wide array of use cases.

Gravity Shift

Compensates for the weight of the optional sunshades and decal rings by shifting the scope housing's center of gravity.

Superior glare reduction

OKULUS features anti-reflective grooves, as well as matte anodizing to minimize glare inside the field of view.

Compatible with Sight Lights

OKULUS features multiple 8-32 threaded attachment holes for popular sight lights. The 45-degree angled mounting hole enables the archer to aim the light at the center of the lens when using a reticle decal.



Developed in cooperation with Japanese leading sports manufacturer MIZUNO, MZS is SHIBUYA's most sophisticated stabilizer system to date.

ULTIMA MZS *New!*

MINIMIZED DRAG ZONE DAMPING STABILIZER

Carbon pipes by



ULTIMA EXTENDER *New!*

The ULTIMA EXTENDER combines SHIBUYA's proven DirectLink construction with High Modulus carbon to achieve an optimal level of stiffness.



MZS is composed of aircraft-grade, high elasticity 60t carbon fiber to achieve exceptional rigidity, and incorporates vibration damping material weaved into the carbon layers of the stabilizer pipe. This enables it to achieve exceptional damping properties while maintaining its high rigidity. At the same time, its slim 14mm diameter minimizes the effects of outside influences such as wind drag. Experience outstanding performance from aiming to follow through, made possible by the state-of-the-art carbon technology incorporated in MZS.

Available sizes
Long Rod: 26", 28", 30" Side Rod: 10", 11", 12", 15"



The Choice of 86% of
Rio Participants!

ULTIMA RECURVE REST

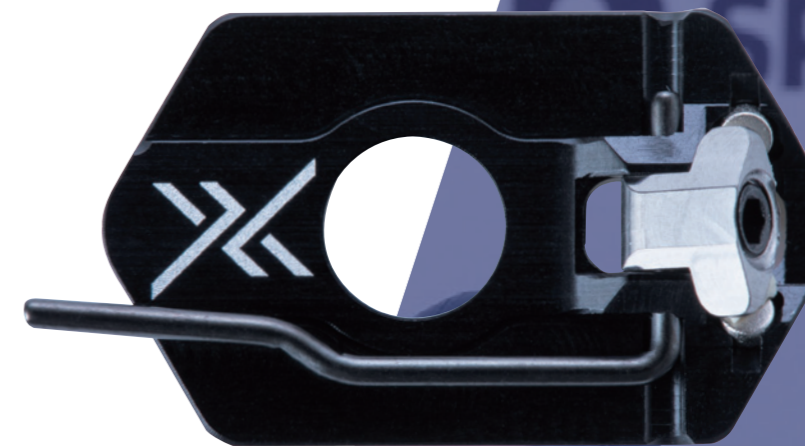

Colors



Dual Adjust System

All adjustments done with a single screw!

Perfect clearance: solid horizontal/vertical adjustment

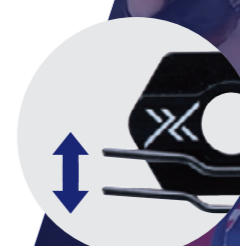

Dual Magnet System

Dual magnets reliably reset the rest pin after each shot.



DLC-Coated Support Arm

Supreme wear resistance and friction reduction. Diamond-Like Carbon coating provides exception friction-reducing properties to help the arrow clear smoothly, reduce speed loss as well as damage to the shaft.



86% of participants in Rio chose the ULTIMA Recurve Rest as their arrow rest. Find out why the vast majority of top-level archers chooses ULTIMA as one of the most integral parts of their setup!

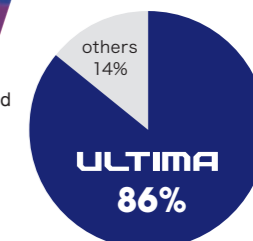

RH
LH



- Offset Arm Construction enables use with small shaft diameters
- Precision CNC-machined parts
- Metric allen wrench and instruction sheet included
- Colors: Black, Silver, Blue, Red, Gold, Pink, Green, Orange

Chung-Tae Kim TAB

Flat Design

The SHIBUYA Chung-Tae Kim Tab features a completely flat plate design by recessing the finger spacer and anchor pad screws into the plate. By allowing the thumb to tuck in beneath the anchor tab, this design enables the archer to achieve a connected anchoring surface with index finger, anchor pad, and thumb. Anchoring has never felt more natural!

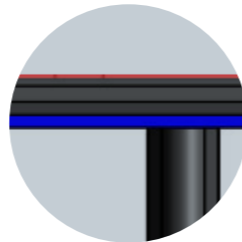

Internal Mount Anchor Pad (pat.pend.)

The SHIBUYA Chung-Tae Tab's Anchor Pad is anchored in between the plate and leather. The archer is able to achieve a consistent anchoring surface to the fingers. The anchor pad naturally moves out of the way, enabling smoother anchoring than ever. The tab plate is covered by the anchor pad, eliminating the need to alter it in order to not protrude from the anchor pad.

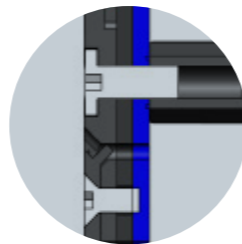

TiltLok Finger Spacer (pat.pend.)

The construction of the Finger Spacer prevents it from tilting, eliminating inconsistency resulting from the angle shifting during use.

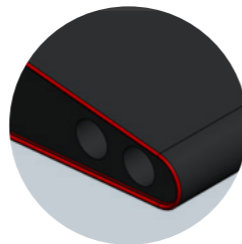

PlateComp Finger Loop

The SHIBUYA Chung-Tae Tab's Finger Tape is fastened by a wedge plate, enabling the archer to adjust it seamlessly to their liking.

All Adjustments can be done with a single Hex Wrench!

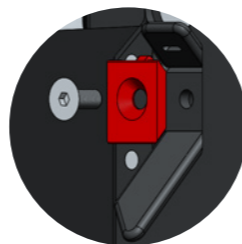

Face Leather	Chung-Tae Kim TAB Original Cordovan Face
Back Leather	Cowhide (Blue)
Size	S, M, L, XL
RH/LH	Available

Size information available at
<http://www.shibuya-archery.com/english/productlist/recurve.html>

DX PLUNGER

The worldwide standard - suitable from beginners to top pros! Includes Teflon and metal-plated tips.

Colors



TRANSPORTER 56.5L BOW CASE

SHIBUYA'S newest recurve bow case offers even more space for gear in a new, sleek design, while keeping the weight exceptionally low! TSA-approved locks and replaceable wheels offer peace of mind for frequent travelers. Includes optional arrow sponge, tie-down straps, multiple zipper pockets. Dimensions: 880×400×210mm Weight: 4.8kg

Colors



BOW CASE [RBT-1000EX]

Robust ABS shell protects your equipment from weather influences and shock-induced damage! Enough space for 2 complete recurve setups. Tie-down straps and inner pockets allow for perfect space organization! Dimensions: 840×320×190mm Weight: 4.9kg

Colors



※ Available colors may vary



Top level performance
ergonomics developed by
a Gold Medalist.





DUAL CLICK

TARGET RECURVE SIGHT

Tournament proven and still going strong!

Ever since we set the standard for target archery sights with the AR-10 in 1979, no other brand of recurve sights has produced more champions or world records than SHIBUYA. The Dual Click line has been the sight of choice for a great number of top-ranked archers, such as the medal-winning Korean National team!

The Dual Click sights now have a reinforced resin windage block to prevent breakage, and feature the popular mounts and click parts proven in the ULTIMA sight series.

Colors



BLACK



Models	DUAL CLICK
Extension Bar	Aluminum
Extension lengths	9"
Elevation lengths	5.20"
Weight	195g
Anodized Color	Black



FIBER OPTIC SIGHT PIN

- 8-32 threaded sight pin for recurve use
- Extra bright 1mm (0.040") diameter fiber optic
- 7 or 12mm outer diameter
- WA legal
- Incl. Red, Green fiber

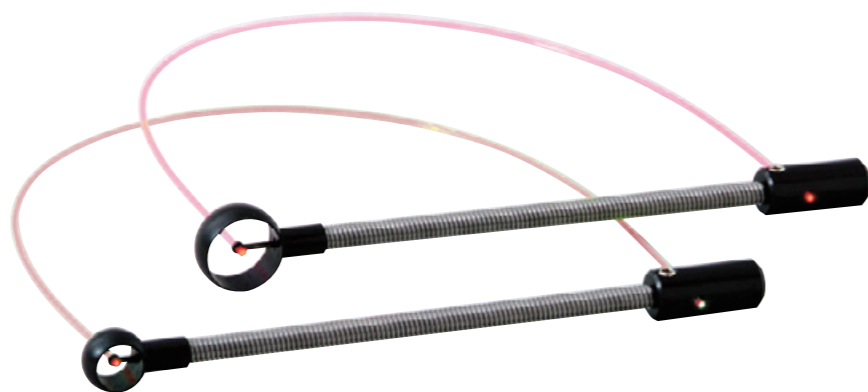

7mm



12mm



Carbon pipes by
Fujikura

CARUNO STABILIZER SYSTEM

LIGHT IS STRONG. CARUNO makes no compromise!

Vari-Blend Carbon -balancing lightness with rigidity-

CARUNO features a unique stabilizer shaft construction, which features carbon blends of varying elastic moduli, placed strategically to maximize performance.

Combined with the DDST construction, this gives CARUNO the solidity and vibration absorption properties high level archers desire. Long Rod and Side Rod employ individually optimized carbon blends, offering superior vibration absorption and stiffness, while reducing torsional rigidity for optimal shooting feeling.

The V-Bar Extender shaft features high torsional rigidity and stiffness, firmly supporting the V-Bar, Long Rod and Side Rods.

Long Rod(1): 26", 28", 30" Side Rod(2): 10", 11", 12"
Available weight modules(3): Flat (32g), Cap(20.4g),
Flat Light (11.2g), Half Cap (11.7g)

(1) Incl. 1Flat weight and 1 Cap weight

(2) Sold in pairs, incl. 1 Cap weight

(3) Flat Light and Half Cap not compatible with some 3rd party dampers or weights

SHIBUYA RECURVE V-BAR CARUNO

Ultra-light: 47g (1.66oz.)! Redefining Weight Distribution

Developed with and for world-class archers

Side red angle: 40, 45

Down angle: 0

Incl. Spanner, V-Bar Bag

Colors



BLACK GUNMETAL

